

PROPRIETARY INFORMATION:

PROPRIETARY OF GLOBTEK, INC. ANY REPRODUCTION, DISCLOSURE OR USE OF THIS DRAWING, IN WHOLE OR IN PART, IS HEREBY PROHIBITED EXCEPT AS SPECIFIED IN WRITING BY GLOBTEK, INC.

REVISION HISTORY

REV	DESCRIPTION	SALES	RFS	DATE	APPROVED
A	Initial Release	SV	27185	10/10/21018	DR
B	Change wire termination length from 255 to 100mm; add label dimensions 50mm (width), 35mm (height)	SV	27223	11/29/2018	DR
C	Update charge temperature from -20°C to 60°C to 0 to 45°C; update battery height dimension from 70.5mm to 68.5mm (Max)	SV	27226	12/3/2018	DR
D	Change Pin Out Pin 2 from N/C to Keying Plug	SV	27227	12/4/2018	DR
E	Update voltage from 3.7 Volts to 3.63 Volts; Update Wh from 28.9Wh to 28.31Wh	SV	27236	12/20/2018	DR
F	Update to include IEC62133 and UN38.3 approvals. Updated battery label to include IEC file designation	SV	27253	1/16/2019	DR
G	Update Keying Plug P/N from 640629 to 641623-1; update pinout Pin 2 from N/C to keying plug; add Caution statement Page 1	SV	27279	2/19/2019	DR
H	Update label from 3.6V to 3.63V	SV	27296	3/15/2019	DR
I	Update wire type from UL 3137 to UL1007; add gift box dimensions to packaging specification	SV	27328	5/6/2019	DR
J	Add picture to show installation of keying plug	SV	27397	7/18/2019	DR
K	Update format, update NTC to 100KΩ Tolerance +/-5%, B=3950K	DR	27549	7/9/2020	DR

See Page 2 for important battery warranty and usage information.

Foot Note:

Globtek Inc. will not be liable for the safety and performance of these power supplies if unauthorized access and repair occurs. End user should consult applicable UL, CSA or EN standards for proper installation instruction.

Limitation of Use:

Globtek product are not authorized for use as mission critical components in life support hazardous environment, nuclear or aircraft applications without prior written approval from the CEO of Globtek Inc.

Contents of this document are subject to change without prior notice

RELEASED
By pudxc at 4:25 pm, Jul 13, 2020

 GlobTek® Inc. www.globtek.com 186 Veterans Drive, Northvale, NJ 07467 Tel. 201-784-1000 Fax 201-784-0111	Drawing Title: Li-Ion Battery	
	3.6 Volts@ 7800mAh	
	Model No.: 18650 (1ICR19/65-3)	
	Part No: BL7800C1865001S3PAVC	Rev. K

PROPRIETARY INFORMATION:

PROPRIETARY OF GLOBTEK, INC. ANY REPRODUCTION, DISCLOSURE OR USE OF THIS DRAWING, IN WHOLE OR IN PART, IS HEREBY PROHIBITED EXCEPT AS SPECIFIED IN WRITING BY GLOBTEK, INC.

By customer signing or accepting this document, they agree to acknowledge and accept the **Guidelines and cautions, Safety Notes, and Safety Precautions published on GlobTek's website**
http://en.globtek.com/safety-cautions.php#.UUD-NRzU_I8

GlobTek offers a 5-year warranty on workmanship and electrical components assembly on all new battery pack products excluding the battery cells themselves which are covered by the Manufacturer's original warranty at their published warranty period. Please refer to the manufacturer's manufacturer's warranty policy for cells. For GlobTek brand cells, GlobTek provides a 12-month warranty for Li-Ion batteries. The warranty period is based upon the expectation that the battery will deliver 80% of its initial capacity after 300 cycles at low to moderate power loads. High power loads may cause a battery to reach 80% of initial capacity in less than the 12-month warranty period. Li-Ion batteries will continue to operate below the 80% capacity threshold; however, the capacity (run time) delivered between charges will continue to decrease.

The purchaser of GlobTek battery pack products (Customer) agrees that they are a "Sophisticated user" who understands battery technology and that it is their sole responsibility to determine suitability of the product described for their application and to take precaution for protection against any hazards attendant to the handling and use of the product. GlobTek products are only designed for professional use and integration by companies into their products and may not be used by consumers directly. GlobTek provides batteries and battery packs as a component of an end system.

The acceptance of GlobTek specifications, the information on this page and use of the product(s) described in this or other GlobTek documents indicate that the product was qualified for use (tested and/or sample waiver signed), and the acceptance and binding of the customer to GlobTek terms and conditions, which supersede all other agreements, terms and conditions
<http://en.globtek.com/terms-and-conditions/>

FIRE HAZARD/WARNING: Unprotected Li-Ion Battery Cells are dangerous and can cause FIRE and loss of life. Acceptance of this quote indicates that the customer listed on this quote has requested to buy unprotected cells, informed GlobTek they are deeply familiar with battery technology and safety, intends to implement proper safety in handling and use of the batteries quotes, is solely responsible for determining the battery cells fitness for use in their application, understands all the risks associated with using Lithium Ion batteries and procuring unprotected cells, and will hold GlobTek harmless from any and all liabilities related to fire, loss of life, property damage, loss or interruption of business, recall, etc.

Customer Approval of Specification:

Please approve, sign and send back to GlobTek so we can complete order processing.

A delay in receipt of this form will delay delivery schedule.

Company Name:

Customer P/N:

Quote Number:

Date:

Authorized Representative Name:

Authorized Representative Signature:

 GlobTek, Inc.
www.globtek.com

186 Veterans Drive, Northvale, NJ 07467
Tel. 201-784-1000 Fax 201-784-0111

Drawing Title: Li-Ion Battery

3.6 Volts @ 7800mAh

Model No.: 18650 (1ICR19/65-3)

Part No.: BL7800C1865001S3PAVC

Rev. K

PROPRIETARY INFORMATION:

PROPRIETARY OF GLOBTEK, INC. ANY REPRODUCTION, DISCLOSURE OR USE OF THIS DRAWING, IN WHOLE OR IN PART, IS HEREBY PROHIBITED EXCEPT AS SPECIFIED IN WRITING BY GLOBTEK, INC.

1. GENERAL SPECIFICATION:

BATTERY WITH SAFETY CIRCUIT AND PLASTIC HOUSING

CELL:	Samsung ICR18650-26
PCM:	N/A
NTC:	100KΩ Tolerance +/-5%, B=3950K
POLYSWITCH	1.20A 15V 100A
CONFIGURATION:	1S3P
WEIGHT:	TBD

2. ELECTRICAL SPECIFICATION:

RATED CAPACITY:	7800(Typical); 7650(Minimim)
NOMINAL VOLTAGE:	3.63 Volts
WATT-HOUR RATING:	28.3Wh
CHARGING METHOD:	CONSTANT CURRENT + CONSTANT VOLTAGE
MAX. CHARGE VOLTAGE [V]:	4.2 (±0.1V)
CHARGE CURRENT:	0.2C (Standard); 0.5C(Max.)
REC. CHARGE CUT OFF:	.01C or by timer approx. 6.5hours
MAX. CONTINUOUS DISCHARGE CURRENT:	1C
REC. DISCHARGE CUT OFF:	3.0V
INTERNAL IMPEDANCE:	≤130 MΩ
EXP. CYCLE LIFE:	>500 cycles > 80% of initial cap. (Charge 0.2C to 4.2V/Discharge 0.2C to 3.0V)

3. AMBIENT CONDITIONS

TEMPERATURE RANGE:	
CHARGE:	0 to +45°C
DISCHARGE:	-20 to +60°C
CHARGE RETENTION/STORAGE [%]:	≤1 year at -20 to +25°C >80% ≤3 months at -20 to +40°C >80% 1 week at -20 to +65°C >80%
HUMIDITY:	60 ±25%RH

4. ENVIRONMENTAL AND SAFETY

PLEASE FOLLOW GlobTek, Inc. HANDLING AND SAFETY PRECAUTIONS FOR Lilon & LiPolymer.

5. CELL REGULATORY APPROVALS:

UL:	Certified to IEC62133
-----	-----------------------

6. BATTERY PACK APPROVALS:

RoHS:	COMPLIES WITH EU 2002/95/EC AND CHINA SJ/T 11363-2006
CE Mark:	COMPLIES WITH 2004/108/EC ELECTROMAGNETIC COMPATIBILITY INCLUDING BUT NOT LIMITED TO EN61000-6-1:2007, EN61000-6-3:2007
TRANSPORTATION:	Approve to UN38.3
Approvals:	Certified to IEC62133-2: 2017



PROPRIETARY INFORMATION:

PROPRIETARY OF GLOBTEK, INC. ANY REPRODUCTION, DISCLOSURE OR USE OF THIS DRAWING, IN WHOLE OR IN PART, IS HEREBY PROHIBITED EXCEPT AS SPECIFIED IN WRITING BY GLOBTEK, INC.

7. MECHANICAL:

DIMENSIONS:	20mm x 56mm x 68.5mm (Max.)
SHRINK WRAP:	White PVC
WIRE TYPE:	UL1007 22 AWG
WIRE LENGTH:	100mm +/- 5mm
WIRE POLARITY:(Pin 1)	Positive (+) Red
WIRE POLARITY:(Pin 2)	Keying Plug
WIRE POLARITY: (Pin 3)	NTC (100k) White
WIRE POLARITY: (Pin 4)	Negative (-) Black
ADDITIONAL REQUIREMENTS:	N/A

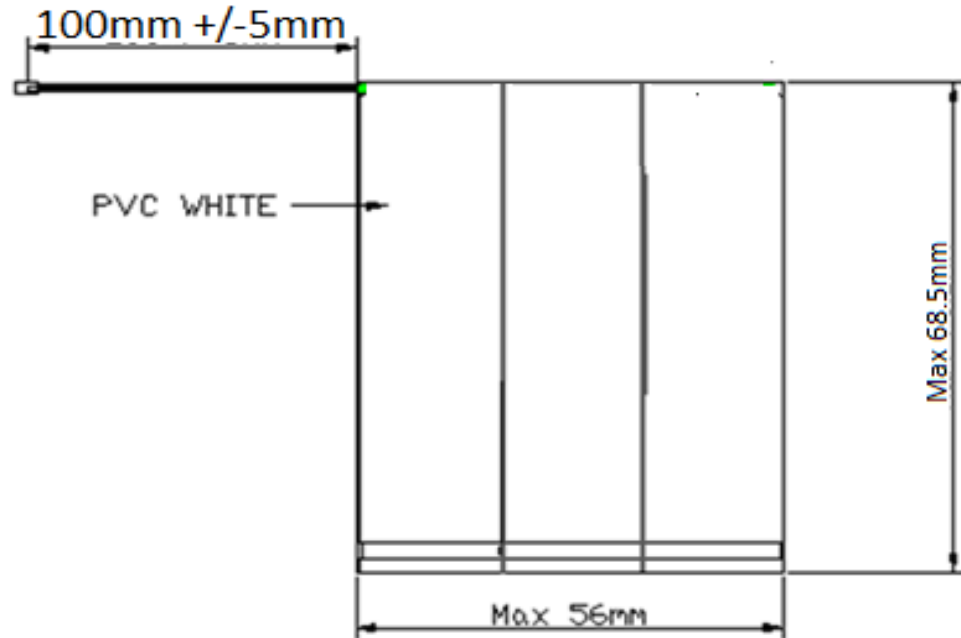

[ADDITIONAL OUTPUT PLUG OPTIONS ARE AVAILABLE BY CLICKING THIS LINK.](#)
[STANDARD PLUGS AND CONNECTORS CAN BE SEEN ONLINE BY CLICKING THIS LINK](#)

GlobTek, Inc.

www.globtek.com

186 Veterans Drive, Northvale, NJ 07467

Tel. 201-784-1000 Fax 201-784-0111

Drawing Title: Li-Ion Battery

3.6 Volts@ 7800mAh

Model No.: 18650 (1ICR19/65-3)

Part No: BL7800C1865001S3PAVC

Rev. K

PROPRIETARY INFORMATION:

PROPRIETARY OF GLOBTEK, INC. ANY REPRODUCTION, DISCLOSURE OR USE OF THIS DRAWING, IN WHOLE OR IN PART, IS HEREBY PROHIBITED EXCEPT AS SPECIFIED IN WRITING BY GLOBTEK, INC.

8. OUTPUT CONNECTOR:

ACTUAL CONNECTOR'S, OVERMOLDS, MAY VARY SLIGHTLY FROM THE PICTURE BELOW



	EQUIVALENT	Y / N	
PLUG TYPE		N	TE P/N 3-640428-4
CONNECTORS KEYING PLUG		N	TE P/N 641623-1
POLARITY:			
PIN 1 (Red)			Positive(+)
PIN 2			Keying Plug
PIN 3 (White)			100k NTC
PIN 4 (Black)			Negative(-)

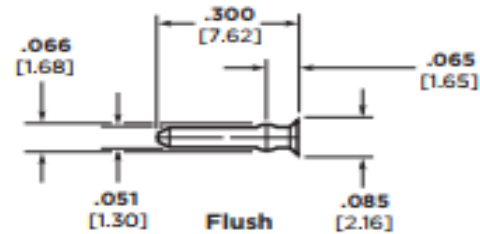
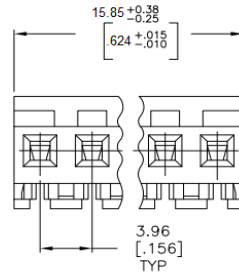
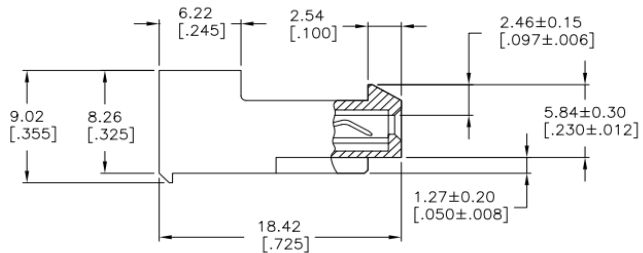
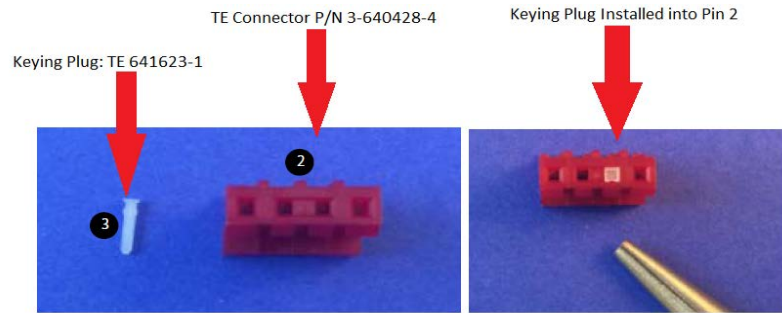
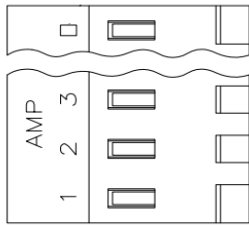

PROPRIETARY INFORMATION:

PROPRIETARY OF GLOBTEK, INC. ANY REPRODUCTION, DISCLOSURE OR USE OF THIS DRAWING, IN WHOLE OR IN PART, IS HEREBY PROHIBITED EXCEPT AS SPECIFIED IN WRITING BY GLOBTEK, INC.

9. LABEL:

MATERIAL:	TBD
BACKGROUND COLOR:	WHITE
TEXT COLOR:	BLACK
LABEL WIDTH: (mm)	50
LABEL HEIGHT: (mm)	35
ADDITIONAL REQUIREMENTS:	N/A

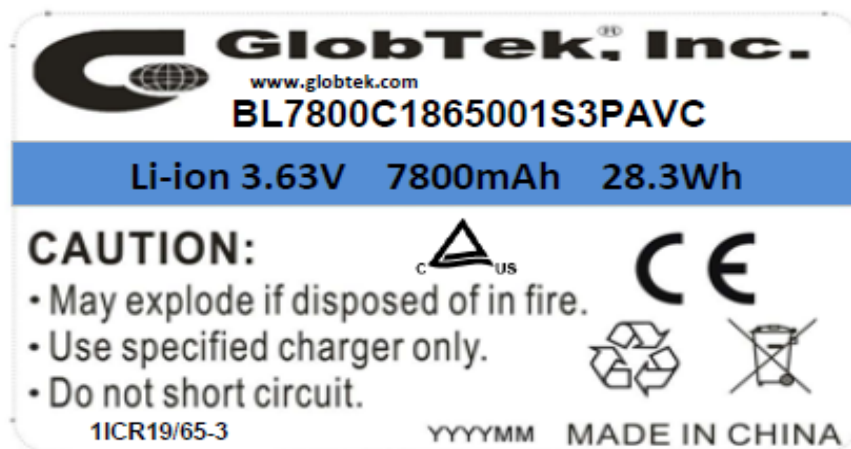

PROPRIETARY INFORMATION:

PROPRIETARY OF GLOBTEK, INC. ANY REPRODUCTION, DISCLOSURE OR USE OF THIS DRAWING, IN WHOLE OR IN PART, IS HEREBY PROHIBITED EXCEPT AS SPECIFIED IN WRITING BY GLOBTEK, INC.

10. PACKAGING:

GIFT BOX SIZE:	95mm*71mm*33mm
CARTON SIZE:	TBD
QUANTITY PER CARTON:	TBD
G.W.	TBD

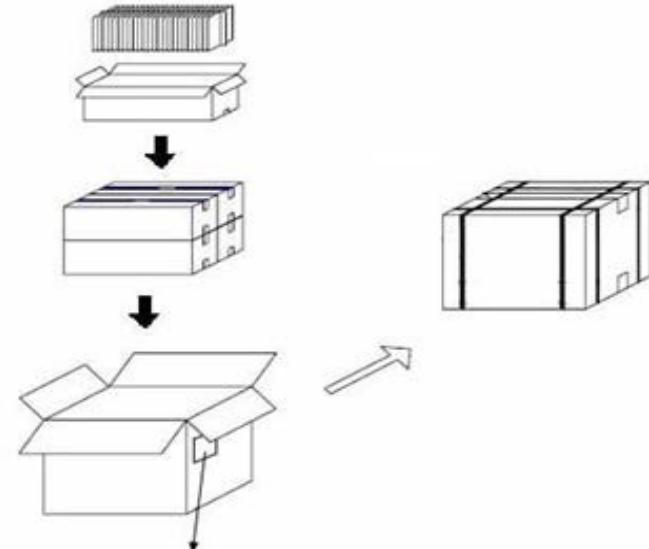

CAUTION LABEL



GlobTek, Inc.

www.globtek.com

186 Veterans Drive, Northvale, NJ 07467

Tel. 201-784-1000 Fax 201-784-0111

Drawing Title: Li-Ion Battery

3.6 Volts@ 7800mAh

Model No.: 18650 (1ICR19/65-3)

Part No: BL7800C1865001S3PAVC

Rev. K