



ISO 9001:2008
REGISTERED

GTM41076 SERIES-6W



6 Watts, Wall Plug-In, Switchmode Power Supply, N.A., European, U.K., SAA Universal Input, Medical, Class II

Part Number Ordering System (See Page 302)
Output Plug/Cord Options (See Page 271)



ELECTRICAL SPECIFICATIONS

INPUT VOLTAGE:
100-240 VAC

INPUT CURRENT:
< 0.5 A RMS MAX

INPUT FREQUENCY:
47 - 63 Hz

OUTPUT VOLTAGE:
SEE TABLE BELOW

OUTPUT CURRENT :
SEE TABLE BELOW

OUTPUT POWER (RATED):
SEE TABLE BELOW

OUTPUT RIPPLE (PEAK TO PEAK):
±1% OR 50 mV WHICHEVER IS GREATER. MEASURED AT 20 MHz BANDWIDTH WITH 0.1 µf CERAMIC CAPACITOR IN PARALLEL WITH 10 µf ELECTROLYTIC CAPACITOR CONNECTED AT THE END OF OUTPUT CONNECTOR

OUTPUT LOAD REGULATION:
±5 % OF NOMINAL OUTPUT VOLTAGE, MEASURED AT O/P CONNECTOR AT NOMINAL LINE

LINE REGULATION:
±1 % OF NOMINAL OUTPUT VOLTAGE MEASURED AT O/P CONNECTOR

TURN ON/ TURN OFF OVERTHOOT:
5% MAX 500µS MAX RECOVERY TIME FOR 25% STEP LOAD

TURN-ON DELAY:
3000 mSEC MAX

HOLD-UP TIME:
8 mSEC MIN AT NOMINAL INPUT AND FULL LOAD

INRUSH CURRENT:
30 A MAX AT COLD START 120 VAC, 60A MAX COLD START 230VAC

SWITCHING FREQUENCY:
66.5 KHz TYPICAL

OVER-VOLTAGE PROTECTION:
PROTECTED, UNIT WILL RECOVER UPON REMOVAL OF FAULT

OVER-CURRENT / SHORT CIRCUIT:
PROTECTED, UNIT WILL RECOVER UPON REMOVAL OF FAULT

OTHER PROTECTION:
INPUT LINE AND NEUTRAL FUSING

SAFETY APPROVALS:

CB CERTIFICATE
LEC 60950-1 :2005 (SECOND EDITION), AM 1: 2009
CB REPORT
IEC 60950-1:2005 (SECOND EDITION), AM 1: 2009 AND OR EN 60950-1:2006 + AM 1:2010 + AM 11:2009 + AM 12:2011
SIQ MARK CERTIFICATE
EN 60950-1 :2006 + AL :2010 +ALL :2009 + A12:2011
UL60601-1, CUL TO 22.2 NO. 601.1-M90, INNOVA BAUART TO EN60601-1, CE CLASS II, PSE TO J60601-1, CB REPORT, C-TICK TO AS/NZ 60601-1, CCC
CERTIFIED COMPLIANCE WITH IP52 PER IEC60529:2001

DIELECTRIC WITHSTAND VOLTAGE:
5656 VDC PRIMARY-SECONDARY

LEAKAGE CURRENT:
< 300 µA AT 240 VAC

EMI:
COMPLIES WITH EN55011 CLASS B AND FCC PART 15 CLASS B WHEN TESTED WITH A RESISTIVE LOAD, BOTH CONDUCTED AND RADIATED

CE MARK:
TESTED TO COMPLY WITH EN61000-3-2, EN61000-3-3, EN60601-1-2 2001, INCLUDING EN61000-4-2, EN61000-4-3, EN61000-4-4, EN61000-4-5, EN61000-4-6, EN61000-4-8, EN61000-4-11.

EFFICIENCY:
COMPLIES WITH ENERGY STAR TIER 2 (NORTH AMERICA), CECP TIER 2 (CHINA), MEPS TIER 2 (AUSTRALIA), CODE OF CONDUCT (EUROPE)

MTBF:
GREATER THAN 200,000 HOURS AT 25°C AMBIENT TEMPERATURE

OPERATING TEMPERATURE:
0°C TO 40° C

STORAGE TEMPERATURE:
-40°C TO 80° C

HUMIDITY:
0% TO 90% RELATIVE HUMIDITY

ROHS:
COMPLIES WITH EU 2002/95/EC AND CHINA SJ/T 11363-2006

NOTE:
DIMENSIONS ARE IN MM UNLESS SPECIFIED OTHERWISE.

OUTPUT VOLTAGE / CURRENT:

| MODEL NUMBER | OUTPUT VOLTAGE (VDC) | OUTPUT CURRENT (A) | RATED OUTPUT POWER (W) |
|-------------------|----------------------|--------------------|------------------------|
| GTM41076-0605-X.X | +5.0 | 0 - 1.2 | 0 - 6.0 |
| GTM41076-0606-X.X | +6.0 | 0 - 1.0 | 0 - 6.0 |
| GTM41076-0607-X.X | +7.0 | 0 - 0.85 | 0 - 6.0 |
| GTM41076-0609-X.X | +9.0 | 0 - 0.66 | 0 - 6.0 |
| GTM41076-0612-X.X | +12.0 | 0 - 0.5 | 0 - 6.0 |
| GTM41076-0615-X.X | +15.0 | 0 - 0.4 | 0 - 6.0 |
| GTM41076-0618-X.X | +18.0 | 0 - 0.33 | 0 - 6.0 |
| GTM41076-0620-X.X | +20.0 | 0 - 0.3 | 0 - 6.0 |
| GTM41076-0624-X.X | +24.0 | 0 - 0.25 | 0 - 6.0 |
| GTM41076-0630-X.X | +30.0 | 0 - 0.20 | 0 - 6.0 |

SPECIFICATIONS MAY CHANGE WITHOUT PRIOR NOTICE. CONSULT GLOBTEK CUSTOMER SERVICE FOR LATEST SPECIFICATIONS.



6 Watts, Wall Plug-In, Switchmode Power Supply, N.A., European, U.K., SAA Universal Input, Medical, Class II

Part Number Ordering System (See Page 302)
Output Plug/Cord Options (See Page 271)



ENCLOSURES

UPPER & LOWER HOUSING: HIGH IMPACT PLASTIC, 94V0 POLYCARBONATE, NON-VENTED, COLOR BLACK



SIZE:
74 x 43.5 x 34 mm

STANDARD OPTION SHIPS WITHOUT AC PINS INSTALLED

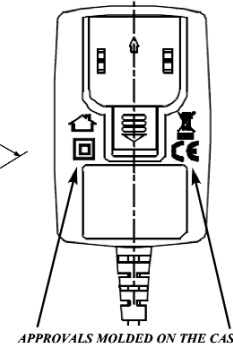
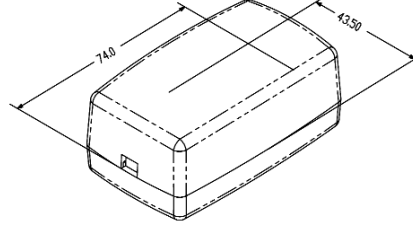
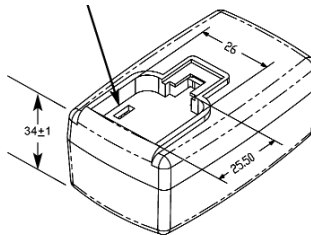

- INPUT CONNECTORS OPTIONS**
Pins or Kits must be ordered separately
- 1 CLASS II MODEL NEMA 1-15P AC POWER PLUG WITH 2 PRONGS, Q-NA
 - 2 AUSTRALIAN CONFIGURATION: SAA 2 PINS CLASS II, Q-SAA
 - 3 UK CONFIGURATION: UK 2 PINS CLASS II, Q-UK
 - 4 EUROPEAN CONFIGURATION: EUROPLUG 2 PINS, CLASS II, Q-EU
 - 5 KOREAN CONFIGURATION, Q-KR
 - 6 ARGENTINA CONFIGURATION, Q-AR
 - 7 CHINA CONFIGURATION, Q-CN

STANDARD OPTION, PINS TO BE ORDERED SEPARATELY

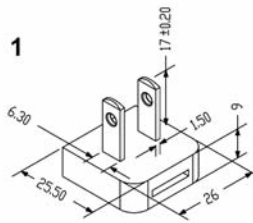
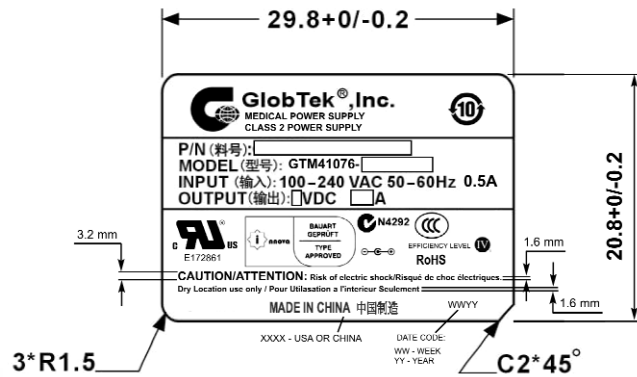

P/N: Q-NA
NORTH AMERICA
JAPAN
CHINA

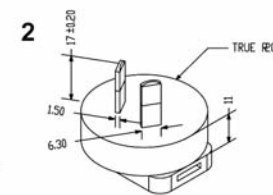

P/N: Q-SAA
AUSTRALIA
CHINA

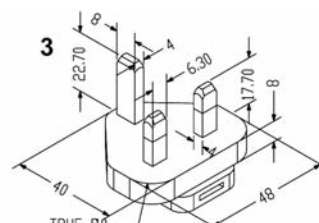

P/N: Q-UK
UNITED KINGDOM
HONG KONG
SINGAPORE

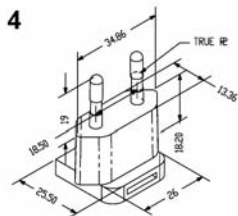

P/N: Q-EU
EUROPE
SOUTH AMERICA

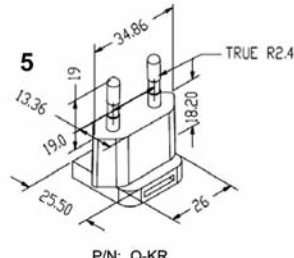

P/N: Q-KR
KOREA

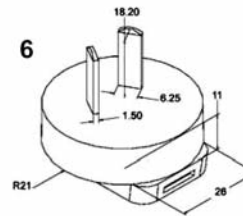

P/N: Q-AR
ARGENTINA

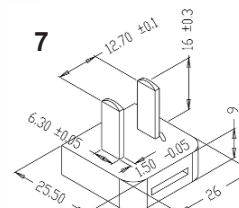

P/N: Q-CN
CHINA

SPECIFICATIONS MAY CHANGE WITHOUT PRIOR NOTICE. CONSULT GLOBTEK CUSTOMER SERVICE FOR LATEST SPECIFICATIONS.