



ISO 9001:2008
REGISTERED



5 Watts, Wall Plug-In, Switchmode Power Supply, N.A.,
European, U.K., SAA Universal Input, ITE, Class II

MTBF=200K
Hours!



ELECTRICAL SPECIFICATIONS

INPUT VOLTAGE:
100-240 VAC

INPUT CURRENT:
< 0.3 A RMS MAX

INPUT FREQUENCY:
50 - 60 HZ

OUTPUT CURRENT:
NO LOAD TO FULL LOAD, NO MINIMUM LOAD REQUIRED

OUTPUT POWER (RATED):
6 WATTS MAX

OUTPUT RIPPLE (PEAK TO PEAK):
100 mV OR 1% OF OUTPUT VOLTAGE,
WHICHEVER IS HIGHER

OUTPUT REGULATION (LINE/LOAD):
5 % FOR MAIN OUTPUT, MEASURED AT O/P CONNECTOR

LINE REGULATION:
+1% MAX AT FULL LOAD

TURN ON/ TURN OFF OVERSHOOT:
5% MAX 500uS MAX RECOVERY TIME FOR 25% STEP LOAD

TURN-ON DELAY:
3000 mSEC MAX

HOLD-UP TIME:
5 mSEC MIN AT NOMINAL INPUT AND FULL LOAD

INRUSH CURRENT:
30 A MAX AT COLD START 120 VAC, 60A MAX COLD
START 230VAC

SWITCHING FREQUENCY:
66.5 KHz TYPICAL

OVER-VOLTAGE PROTECTION:
VOLTAGE LIMITED LESS 150% OF NOMINAL VOLTAGE

OVER-CURRENT / SHORT CIRCUIT:
HICCUP WITH AUTO RECOVERY TO 1.1 - 1.3 IO

OTHER PROTECTION:
INPUT FUSING

SAFETY APPROVALS (PENDING):

UL 60950-1, CUL TO 22.2# 60950-1, SIQ TO EN60950-1,
CCC TO GB4943-2001, GB9254-1998, GB17625.1-2003, CE
CLASS II, PSE TO J60950, CB REPORT

DIELECTRIC WITHSTAND VOLTAGE:
4242VDC PRIMARY-SECONDARY

LEAKAGE CURRENT:
< 3.5 mA @ 240VAC

EMI:
COMPLIES WITH EN55022 CLASS B AND FCC PART 15 CLASS
B WHEN TESTED WITH A RESISTIVE LOAD, BOTH CONDUCT-
ED AND RADIATED EMI.

CE MARK:
TESTED TO COMPLY WITH EN61000-3-2 EN61000-3-3 AND
EN50082-1, INCLUDING EN61000-4-2, EN61000-4-3, EN61000-4-
4, EN61000-4-5, EN61000-4-6, EN61000-4-11.

EFFICIENCY:
COMPLIES WITH ENERGY STAR (NORTH AMERICA),
CECP (CHINA), MEPS (AUSTRALIA), CODE OF
CONDUCT (EUROPE)

MTBF:
GREATER THAN 200,000 HOURS AT 25°C AMBIENT
TEMPERATURE

OPERATING TEMPERATURE:
0°C TO 40° C

STORAGE TEMPERATURE:
-40°C TO 80° C

HUMIDITY:
0% TO 90% RELATIVE HUMIDITY

NOTES:

1. EACH OUTPUT CURRENT MAY VARY WITHIN IT'S DESIGNA-
TION RANGE, AS LONG AS OUTPUT POWER IS NOT
EXCEEDED.
2. SINGLE OUTPUT MAY VARY FROM 3VDC-24VDC IN 0.1V
INCREMENTS
3. (-.Y.Y) OPTIONAL FOR SPECIFYING OUTPUT VOLTAGE DEVI-
ATION FROM LISTED RATINGS. SUBTRACT Y.Y FROM RATED
VOLTAGE.

OUTPUT VOLTAGE / CURRENT:

MODEL NUMBER	PART NUMBER	OUTPUT VOLTAGE (VDC)	OUTPUT CURRENT (A)	RATED OUTPUT POWER (W)	COUNTRY
GT-81082-0506.5-USB-W2A	WR97A1000USB-F(R)	+5.0	0 - 1.0	0 - 5.0	Australia/NZ
GT-81082-0506.5-USB-W2E	WR93A1000USB-F(R)	+5.0	0 - 1.0	0 - 5.0	Europe
GT-81082-0506.5-USB-W2K	WR9U7A1000USB-F(R)	+5.0	0 - 1.0	0 - 5.0	Korea
GT-81082-0506.5-USB-W2	WR92A1000USB-F(R)	+5.0	0 - 1.0	0 - 5.0	North America/Japan/China
GT-81082-0506.5-USB-W2U	WR94A1000USB-F(R)	+5.0	0 - 1.0	0 - 5.0	UK

SPECIFICATIONS MAY CHANGE WITHOUT PRIOR NOTICE. CONSULT GLOBTEK CUSTOMER SERVICE FOR LATEST SPECIFICATIONS.



5 Watts, Wall Plug-In, Switchmode Power Supply, N.A.,
European, U.K., SAA Universal Input, ITE, Class II



ENCLOSURES

UPPER & LOWER HOUSING: HIGH IMPACT PLASTIC, 94V0 POLYCARBONATE, NON-VENTED, COLOR BLACK



GT-81082-0505-W2A

Australia/NZ

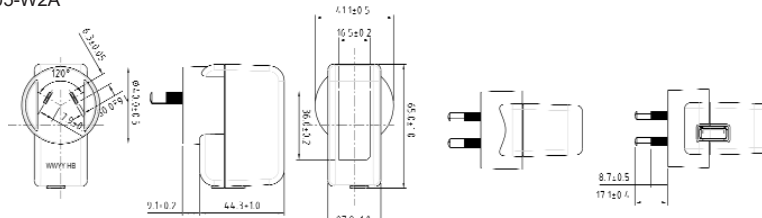

GT-81082-0505-W2E

Europe

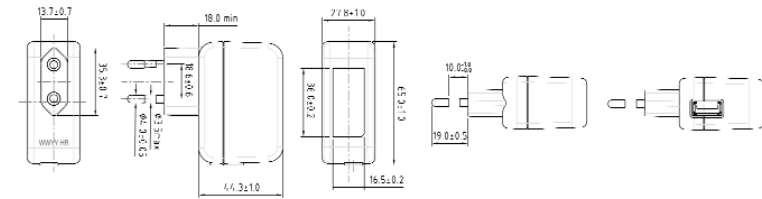

GT-81082-0505-W2K

Korea

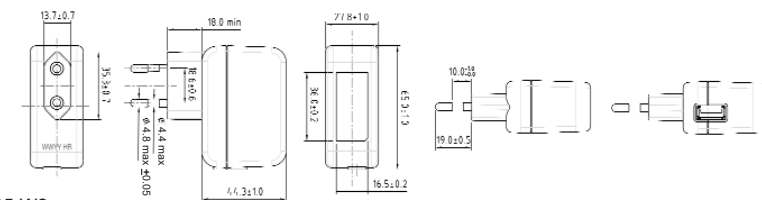

GT-81082-0505-W2

North America/Japan/China

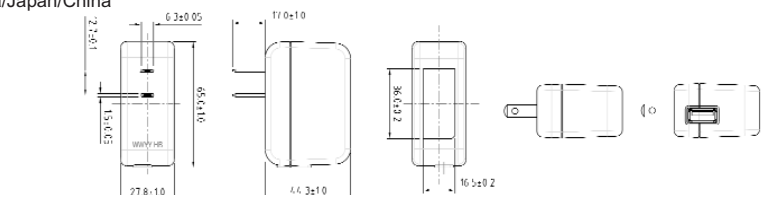

GT-81082-0505-W2U

UK

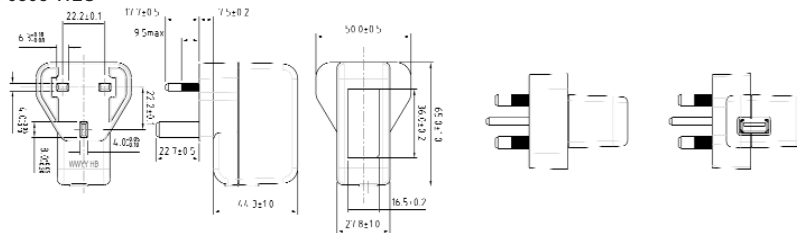

OUTPUT CONFIGURATION:

USB, TYPE A,

PIN 1 = +V

PIN 4 = COM

