



ISO 9001:2000
REGISTERED

**0-20 Watts, Desktop Universal Input, ITE
Triple Output Switchmode Supply**

Part Number Ordering System (See Page 224)
Output Plug/Cord Options (See Page 189)



INDOOR USE ONLY

ELECTRICAL SPECIFICATIONS:

INPUT VOLTAGE:

90 VAC TO 264 VAC

INPUT CURRENT:

< 1.0 A RMS AT 90 VAC INPUT

INPUT FREQUENCY:

47 HZ - 63 HZ

OUTPUT CURRENT:

NO LOAD TO FULL LOAD, NO MINIMUM LOAD REQUIRED

OUTPUT POWER (RATED):

15 WATTS MAX

OUTPUT RIPPLE (PEAK TO PEAK):

≤ 1% TYPICAL

OUTPUT REGULATION (LINE/LOAD):

± 5 % FOR MAIN OUTPUT, +5% FOR SECOND AND

± 10% FOR THIRD OUTPUT (10% MIN. LOAD ON MAIN OUTPUT)

TURN ON/ TURN OFF OVERTHOOT:

4% MAX 500 uS MAX RECOVERY TIME FOR 25% STEP LOAD

TURN-ON DELAY:

1 SEC MAX

HOLD-UP TIME:

16 mSEC MIN AT NOMINAL INPUT AND FULL LOAD

INRUSH CURRENT:

20 A MAX AT COLD START FOR N.A. (40A FOR EURO)

EFFICIENCY:

75 % TYPICAL

SWITCHING FREQUENCY:

100 KHZ TYPICAL

OVER-VOLTAGE PROTECTION:

VOLTAGE LIMITED LESS 130% OF NOMINAL VOLTAGE FOR
MAIN OUTPUT

OVER-CURRENT / SHORT CIRCUIT:

1.1 - 1.3 IO HICCUP WITH AUTO RECOVERY

OTHER PROTECTION:

INPUT FUSING

SAFETY APPROVALS:

UL 60950, PSE TO J60950, CUL TO 22.2 # 234, 950, TUV TO EN
60950, CE CLASS I

DIELECTRIC WITHSTAND VOLTAGE:

4242VDC (3000VAC) PRIMARY-SECONDARY;

2121VDC (1500VAC) PRIMARY- GROUND

LEAKAGE CURRENT:

3.5 mA MAX

LINE SURGE:

EN 61000-4-5 LEVEL 4

EMI:

COMPLIES WITH EN55022, CLASS B AND FCC PART 15
CLASS B WHEN TESTED WITH A RESISTIVE LOAD, BOTH
CONDUCTED AND RADIATED

CE MARK:

TESTED TO COMPLY WITH EN61000-3-2, EN61000-3-3 AND
EN50082-1 INCLUDING EN61000-4-2, EN61000-4-3,
EN61000-4-4, EN61000-4-5, EN61000-4-6, EN61000-4-11
LEVEL 4, UNIT IS ELIGIBLE FOR CE MARK

MTBF:

SHALL BE 50,000 HOURS OR GREATER AT 25°C AMBIENT
TEMPERATURE

OPERATING TEMPERATURE:

0° C TO 40° C

STORAGE TEMPERATURE:

-40° C TO 80° C

HUMIDITY:

0% TO 90% RELATIVE HUMIDITY

NOTES:

DIMENSIONS ARE IN MM UNLESS SPECIFIED OTHERWISE.



OUTPUT VOLTAGE / CURRENT:

MODEL NUMBER	OUTPUT VOLTAGE (VDC)	OUTPUT CURRENT (A)	RATED OUTPUT POWER (W)
GT-4203D-1A	+ 5	2.0	0 - 20
	+ 12	0.2	0 - 20
	- 12	0.2	0 - 20
GT-4203D-1	+ 5	2.0	0 - 20
	+ 12	1.0	0 - 20
	- 12	0.2	0 - 20

SPECIFICATIONS MAY CHANGE WITHOUT PRIOR NOTICE. CONSULT GLOBTEK CUSTOMER SERVICE FOR LATEST SPECIFICATIONS.



ISO 9001:2000
REGISTERED

GT-4203D SERIES-20W

0-20 Watts, Desktop Universal Input, ITE Triple Output Switchmode Supply

Part Number Ordering System (See Page 224)
Output Plug/Cord Options (See Page 189)



ENCLOSURES

HOUSING: HIGH IMPACT PLASTIC, 94V0 POLYCARBONATE, COLOR BLACK

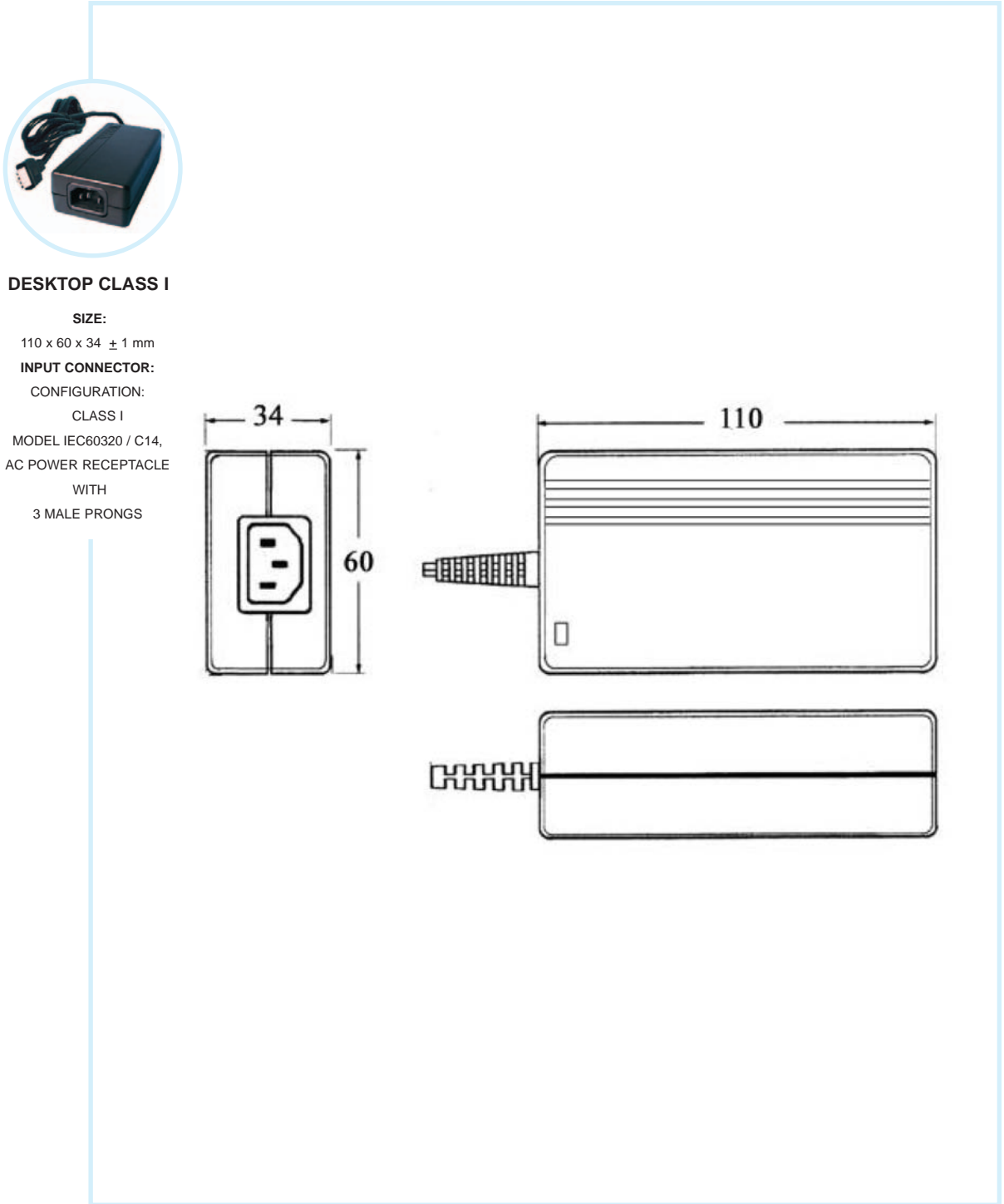

DESKTOP CLASS I

SIZE:

110 x 60 x 34 ± 1 mm

INPUT CONNECTOR:

CONFIGURATION:

CLASS I

MODEL IEC60320 / C14,

AC POWER RECEPTACLE

WITH

3 MALE PRONGS



SPECIFICATIONS MAY CHANGE WITHOUT PRIOR NOTICE. CONSULT GLOBTEK CUSTOMER SERVICE FOR LATEST SPECIFICATIONS.