



ISO 9001:2000  
REGISTERED

**0-20 Watts , Desktop Universal Input, ITE  
Dual Output Switchmode Supply**

Part Number Ordering System (See Page 224)  
Output Plug/Cord Options (See Page 189)

INDOOR USE ONLY



**ELECTRICAL SPECIFICATIONS:**

**INPUT VOLTAGE:**

90 VAC TO 264 VAC

**INPUT CURRENT:**

< 1.0 A RMS AT 90 VAC INPUT

**INPUT FREQUENCY:**

47 HZ - 63 HZ

**OUTPUT POWER (RATED):**

15 WATTS MAX

**OUTPUT RIPPLE (PEAK TO PEAK):**

≤ 1% TYPICAL

**OUTPUT REGULATION (LINE/LOAD):**

± 5 % FOR MAIN OUTPUT, +5% FOR SECOND AND

± 10% FOR THIRD OUTPUT ( 10% MIN. LOAD ON MAIN OUTPUT)

**TURN ON/ TURN OFF OVERSHOOT:**

4% MAX 500  $\mu$ S MAX RECOVERY TIME FOR 25% STEP LOAD

**TURN-ON DELAY:**

1 SEC MAX

**HOLD-UP TIME:**

16 mSEC MIN AT NOMINAL INPUT AND FULL LOAD

**INRUSH CURRENT:**

20 A MAX AT COLD START FOR N.A. (40A FOR EURO)

**EFFICIENCY:**

75 % TYPICAL

**SWITCHING FREQUENCY:**

100 KHZ TYPICAL

**OVER-VOLTAGE PROTECTION:**

VOLTAGE LIMITED LESS 130% OF NOMINAL VOLTAGE FOR  
MAIN OUTPUT

**OVER-CURRENT / SHORT CIRCUIT:**

1.1 - 1.3 IO HICCUP WITH AUTO RECOVERY

**OTHER PROTECTION:**

INPUT FUSING

**SAFETY APPROVALS:**

UL 60950 / 1950, CUL T 22.2 # 234, 950, TUV TO EN 60950,

CE CLASS I, PSE TO J60950

**DIELECTRIC WITHSTAND VOLTAGE:**

1500VAC PRIMARY-SECONDARY;1500 VAC PRIMARY- GROUND

**LEAKAGE CURRENT:**

3.5 mA MAX

**LINE SURGE:**

EN 61000-4-5 LEVEL 4

**EMI:**

COMPLIES WITH EN55022, CLASS B AND FCC PART 15  
CLASS B WHEN TESTED WITH A RESISTIVE LOAD, BOTH  
CONDUCTED AND RADIATED

**CE MARK:**

TESTED TO COMPLY WITH EN61000-3-2, EN61000-3-3 AND  
EN50082-1 INCLUDING EN61000-4-2, EN61000-4-3,  
EN61000-4-4, EN61000-4-5, EN61000-4-6, EN61000-4-11  
LEVEL 4, UNIT IS ELIGIBLE FOR CE MARK

**MTBF:**

SHALL BE 50,000 HOURS OR GREATER AT 25°C AMBIENT  
TEMPERATURE

**OPERATING TEMPERATURE:**

0° C TO 40° C

**STORAGE TEMPERATURE:**

-40° C TO 80° C

**HUMIDITY:**

0% TO 90% RELATIVE HUMIDITY

**NOTES:**

DIMENSIONS ARE IN MM UNLESS SPECIFIED OTHERWISE.



**OUTPUT VOLTAGE / CURRENT:**

MODEL NUMBER	OUTPUT VOLTAGE (VDC)	OUTPUT CURRENT (A)	RATED OUTPUT POWER (W)
GT-4202D-2A	+ 5	2.5	0 - 20
	+ 12	0.5	
GT-4202D-2	+ 5	2.5	0 - 20
	+ 12	0.8	
GT-4202D-1A	+ 5	1.5	0 - 20
	+ 12	1.5	

SPECIFICATIONS MAY CHANGE WITHOUT PRIOR NOTICE. CONSULT GLOBTEK CUSTOMER SERVICE FOR LATEST SPECIFICATIONS.



ISO 9001:2000  
REGISTERED

## GT-4202D SERIES-20W

### 0-20 Watts, Desktop Universal Input, ITE Dual Output Switchmode Supply

Part Number Ordering System (See Page 224)  
Output Plug/Cord Options (See Page 189)



 INDOOR USE ONLY



#### ENCLOSURES

HOUSING: HIGH IMPACT PLASTIC, 94V0 POLYCARBONATE, COLOR BLACK, CUSTOMER SPECIFIED COLOR AVAILABLE UPON REQUEST.

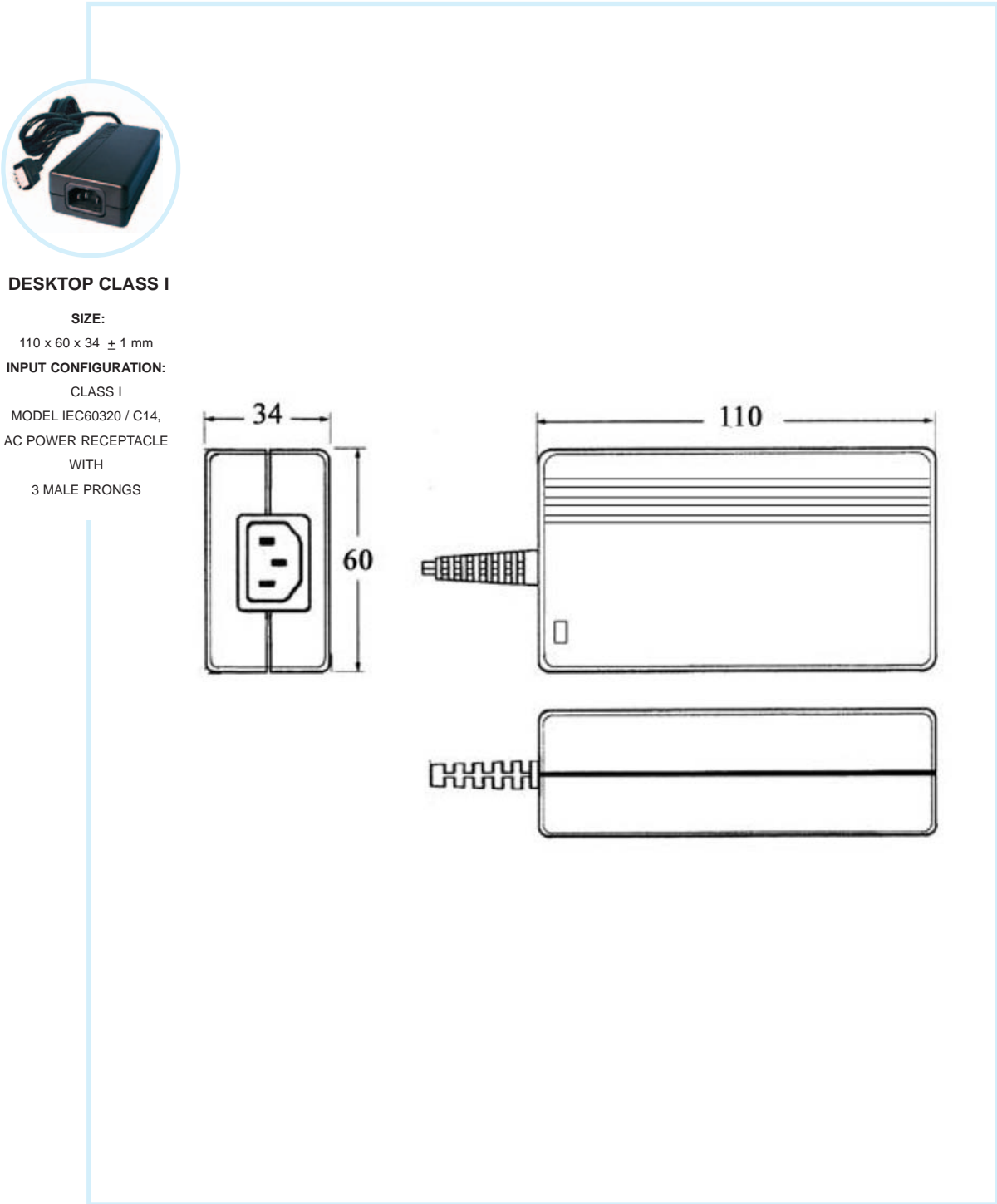

#### DESKTOP CLASS I

**SIZE:**

110 x 60 x 34 ± 1 mm

**INPUT CONFIGURATION:**

CLASS I

MODEL IEC60320 / C14,

AC POWER RECEPTACLE

WITH

3 MALE PRONGS

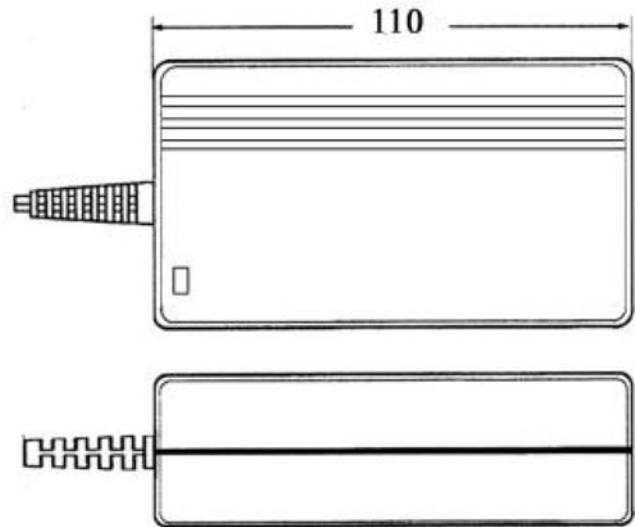
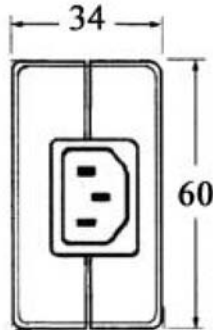

SPECIFICATIONS MAY CHANGE WITHOUT PRIOR NOTICE. CONSULT GLOBTEK CUSTOMER SERVICE FOR LATEST SPECIFICATIONS.